

SEAT KIT INSTALLATION INSTRUCTIONS CLUB CAR DS

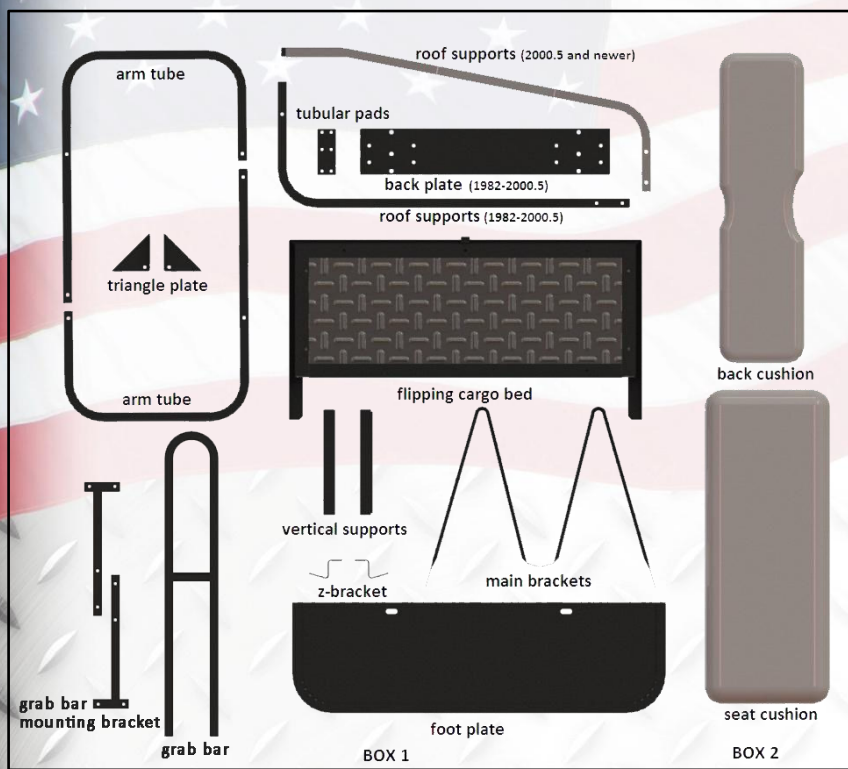

BAG#	Function	Hardware	Specification	Qty
C-1	Armtube	hex bolt	1/4-1 1/2	4
		hex bolt	1/4-2 1/2	2
		flat washer	1/4	12
		lock nuts	1/4	6
C-2	Flipping cargo bed	hex bolt	1/4-1	4
		flat washer	1/4	8
		lock nuts	1/4	4
C-3	footplate and vertical supports to bumper mounting hole	hex bolt	3/8-1 3/4	2
		flat washer	3/8	4
		spring washers	3/8	2
		nut	3/8	2
C-4	roof struts to arm tubes	hex bolt	1/4-2 1/2	4
		flat washer	1/4	8
		lock nuts	1/4	4
C-5	main brackets to cart	hex bolt	5/16-1 1/2	6
		flat washer	5/16	6
		Lock Nut	5/16	6
C-6	main brackets and tubular pads to driver's backcushion	hex bolt	1/4-3	4
		flat washer	1/4	4
C-6	main brackets and tubular pads to driver's back cushion	hex bolt	1/4-1 3/8	8
		hex bolt	1/4-1	4
		flat washer	1/4	12
		lock nut	1/4	4
C-7	Back cushion	hex bolt	1/4-1 3/8	4
		flat washer	1/4	4
	Seat cushion	self-drill screw	M4.2*30	6
C-8	Grab bar	hex bolt	1/4-1 3/4	8
		flat washer	1/4	16
		lock nut	1/4	8

INSTALLATION



Step 1 Remove all rear accessories, canopy, struts, bumper, motor cover, front seat back and bracket. Retain canopy hardware for later use.



Step 2 Install foot plate & vertical supports on the bumper mounting holes. Use Hardware C-3.

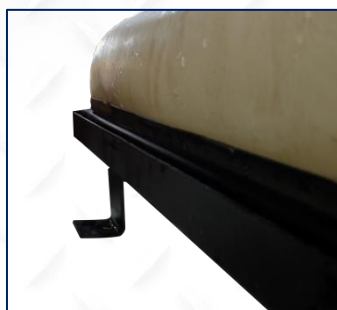

Step 3 Install two Z-brackets on the front edge of the lower part of the flipping cargo bed, use hardware C-2. Install seat cushion on flipping cargo bed, use hardware C-7.



Step 4 Install main bracket on the cart. Install front part of main bracket on the cart, use hardware C-5. Sandwiched Z-Bracket between the main bracket and the cart, use hardware C-5.

SEAT KIT INSTALLATION INSTRUCTIONS CLUB CAR DS



Step 5 Install rear part of flipping cargo bed onto the vertical supports. Use Hardware C-2.



Step 6 Install arm tube to flipping cargo bed and to foot plate, make sure the bolt points outwards. Use Hardware C-1 (LONGER ONES ON FOOT PLATE SIDE.) NOTE: install triangle brackets between armrest and under footplate.



Step 7 Install roof struts to the front side of the arm tube. Use Hardware C-4.



2000 and up

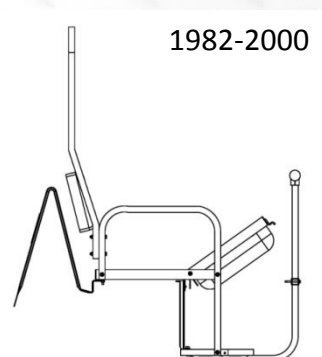

1982-2000

Correct roof strut direction



Step 8 Reattach access engine cover. Install rear seat back cushion to the main bracket. Use Hardware C-7.



1982 to 2000.5

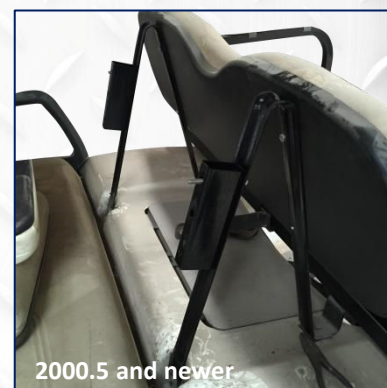

2000.5 and newer

Step 9 Install tubular pads (for 2000.5+) or back plate (for 1982 to 2000.5) to main brackets, then reattach front seat back. Use Hardware C-6.

GRAB BAR INSTALLATION INSTRUCTIONS

FITS ALL STEELENG REAR FLIP SEAT KIT

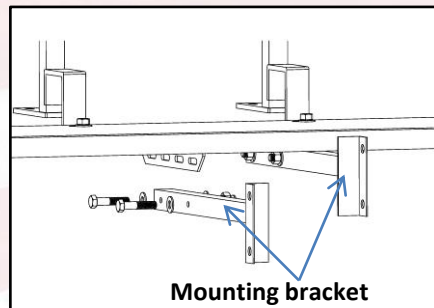
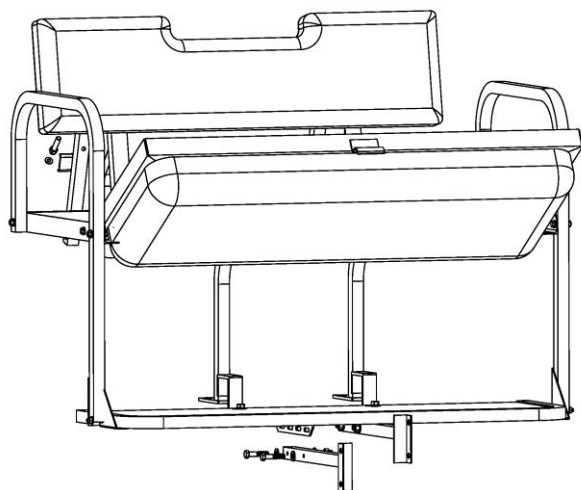
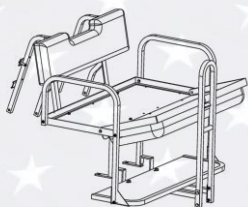

1. Install mounting bracket to footplate using 4 supplied 1/4-1 3/4 bolts, washers and nuts.

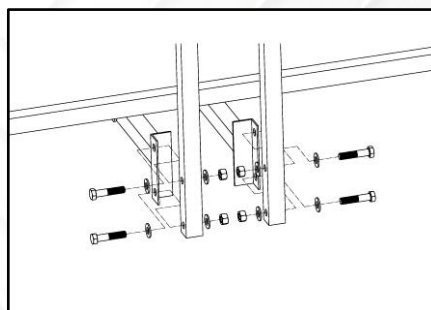
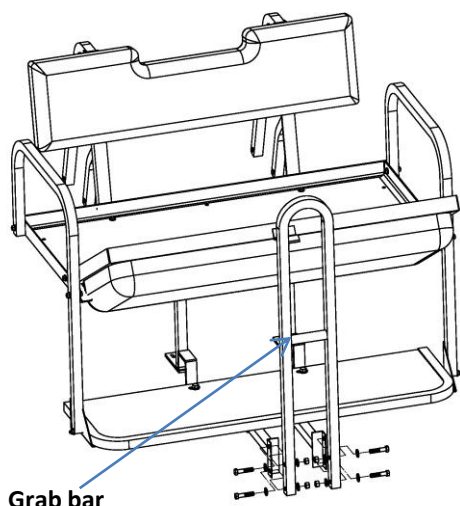

2. Install grab bar to mounting bracket using 4 supplied 1/4-1 3/4 bolts, washers and nuts.

Please refer to below chart to identify your hardware bag# to install grab bar.

Cart Style	Hardware Bag#	Cart Style	Hardware Bag#
EZGO TXT	B-7	EZGO RXV	R-5
Club Car DS	C-8	Club Car Precedent	A-6
Yamaha G14-G22	E-7	Yamaha Drive	D-7

All specifications mentioned above are subject to change without prior notice.



RETURN MERCHANDISE AUTHORIZATION

Dear Valued Customer,

Thank you for choosing Steeleng Golf Cart Accessories for your golf cart needs.

We apologize for the issues you are having with your purchase. We strive to offer the absolute best quality at the absolute best price.

To best serve you, we do need a little information to help process your return and/or exchange faster.

Please complete the following and include this entire form with your return.

Name

Shipped To Address

STATE

ZIP

Purchased with: eBay

Direct Phone Order

This is for EXCHANGE REFUND

Please describe reason for return:-

Our Return Address:

Steeleng Golf Cart Accessories

3309 Laurens Road,

Greenville, SC 29607

Tele: 864-675-1103

For Office Use Only:

Received By: _____

Date _____

Refund Amount _____

Exchange Issued _____

****Steeleng Golf Cart Accessories reserves the right to charge a 15% restocking fee for all returned and/or exchanged items.**